

Plastic square shape inductive sensors **LE40SZ** series



Features

- ◆ Extended sensing distance;
- ◆ ASIC design, safe and reliable;
- ◆ Perfect choice for metallic target detection;



Part number

AC/DC 2wires NO	LE40SZSF20SBOY-E2	LE40SZSN40SBOY-E2	AC/DC 2wires NO/NC	LE40SZSF20SBBY-E2	LE40SZSN40SBBY-E2
AC/DC 2wires NC	LE40SZSF20SBCY-E2	LE40SZSN40SBCY-E2			

Technical specifications

Mounting	Quasi -flush	Non-flush	Leakage current [Ir]	AC: ≤3mA	DC: ≤1mA
Rated distance [Sn]	20mm	40mm	Circuit protection	
Assured distance [Sa]	0...16mm	0...32mm	Indicator	Yellow LED	
Dimensions	40 mm *40 mm *66mm		Ambient temperature	-25°C...70°C	
Output	NO/NC(depends on part number)		Ambient humidity	35-95%RH	
Supply voltage	20...250V AC/DC		Switching frequency [F]	AC:20 Hz	DC: 100 Hz
Standard target	Fe 60*60*1t	Fe 120*120*1t	Voltage withstand	1000V/AC 50/60Hz 60S	
Switch-point drifts[%/Sr]	≤±10%		Insulation resistance	≥50MΩ (500VDC)	
Hysteresis range [%/Sr]	1...20%		Vibration resistance	10...50Hz (1.5mm)	
Repeat accuracy [R]	≤3%		Degree of protection	IP67	
Load current	AC:≤300mA DC: ≤100mA		Housing material	PBT	
Residual voltage	AC:≤10V DC: ≤8V		Connection type	M12 connector	

Dimensions

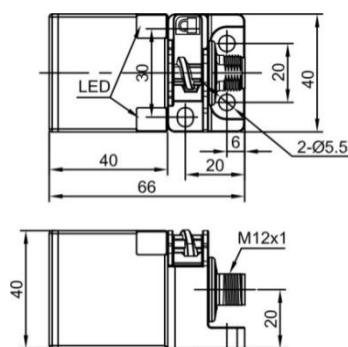

Wiring diagram

